

2 - 40GHz Left Hand Circularly Polarised Spiral Antenna fitted with an K type Connector and Radome

### QMS-00934

### Typical Specification

<b>Frequency</b>	2 to 40 GHz
<b>Connector</b>	2.92 (K-type) Female
<b>VSWR</b>	Typically <2:1
<b>Gain</b>	-4.4 to 5.2 dBi
<b>Axial Ratio</b>	0.3 to 5.8 dB
<b>3 dB Beamwidth</b>	61.2 to 122.9 degrees
<b>10 dB Beamwidth</b>	125.2 to 196.8 degrees
<b>Power</b>	Typically, 5 Watts c.w
<b>Size &amp; Weight</b>	Ø50.5mm x 45 mm (D x H), 140g
<b>Mounting</b>	3 x M3 Thru on Ø38.1 mm PCD
<b>Environmental</b>	Please contact Steatite for advice.

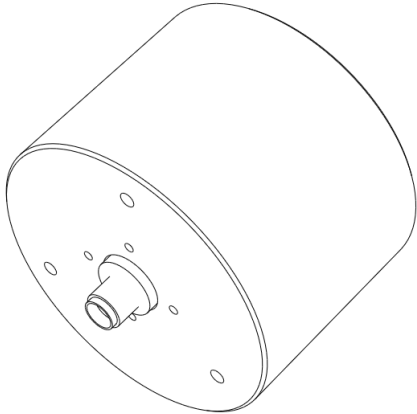

Please contact Steatite Antennas for a full interface control drawing.

### Typical Gain

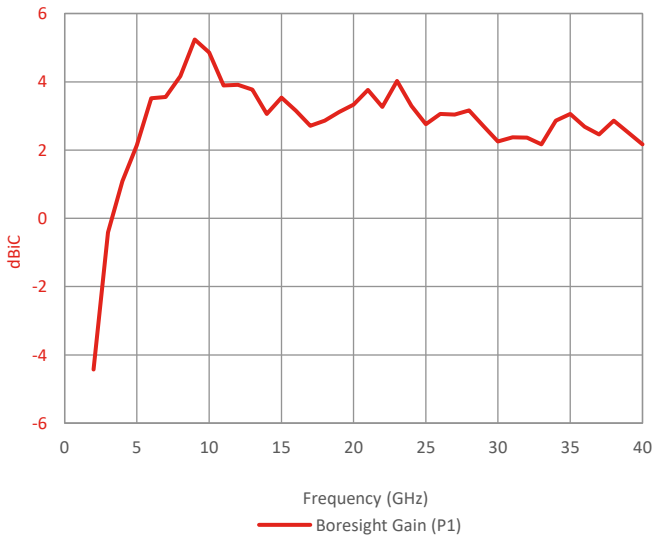

### Typical Beamwidth

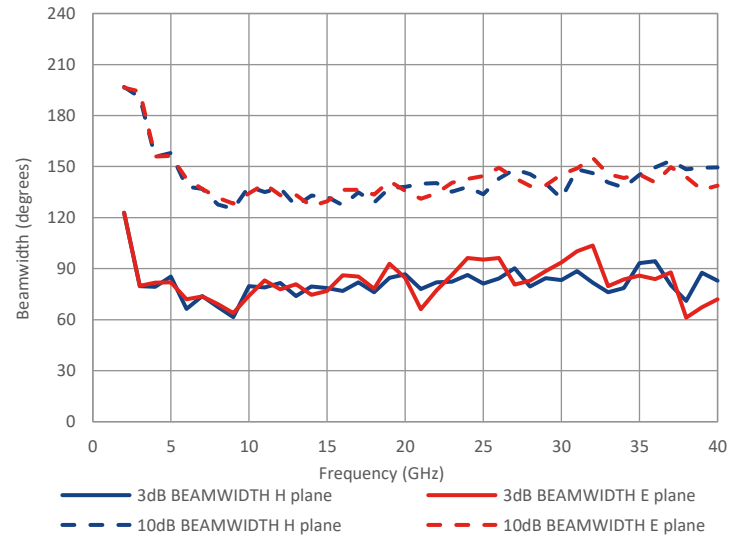

### Typical VSWR

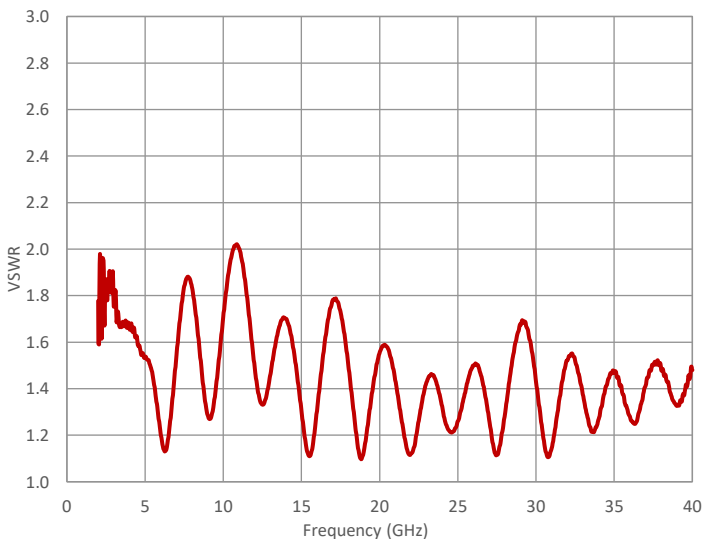

### Typical Axial Ratio

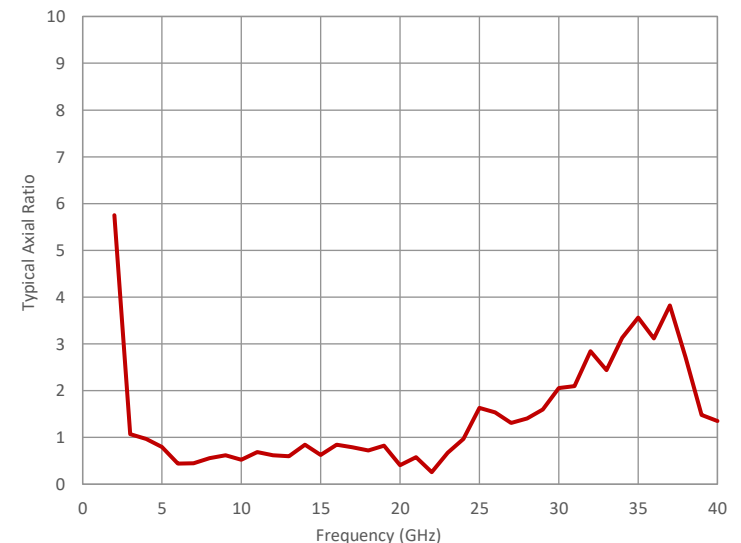

Steatite Antennas reserve the right to change and/or update this specification whereby it is deemed that this would improve either the production and/or performance specification of this part. Information herein should not be disclosed to a third party without the prior written consent of Steatite Antennas.

BP 12/06/2024 6216

