

QMS-00933

Typical Specification

Frequency	2 to 40 GHz
Connector	2.92 (K-type) Female
VSWR	Typically <2:1
Gain	-4.4 to 5.2 dBi
Axial Ratio	0.3 to 5.8 dB
3 dB Beamwidth	61.2 to 122.9 degrees
10 dB Beamwidth	125.2 to 196.8 degrees
Power	Typically, 5 Watts c.w
Size & Weight	Ø50.5mm x 45 mm (D x H), 140g
Mounting	3 x M3 Thru on Ø38.1 mm PCD
Environmental	Please contact Steatite for advice.

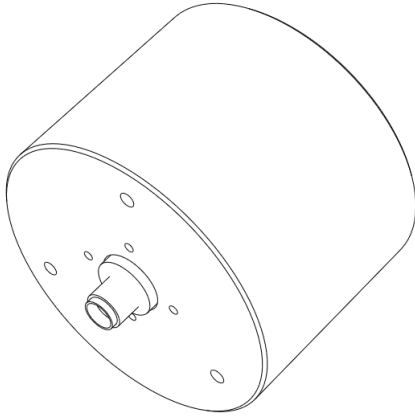

Please contact Steatite Antennas for a full interface control drawing.

Typical Gain

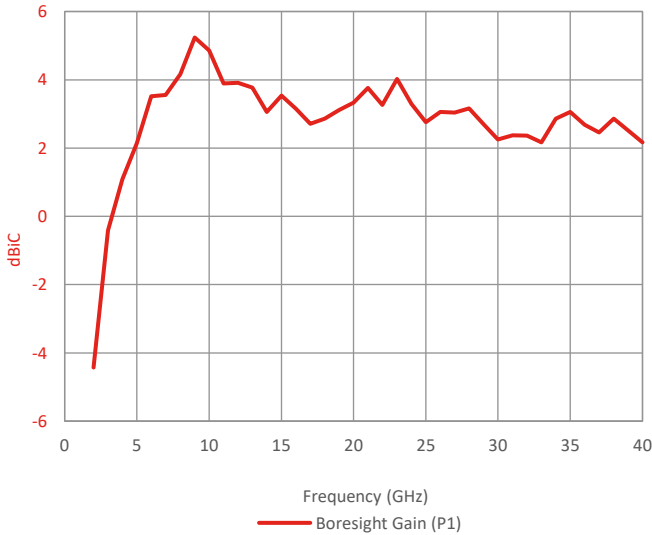

Typical Beamwidth

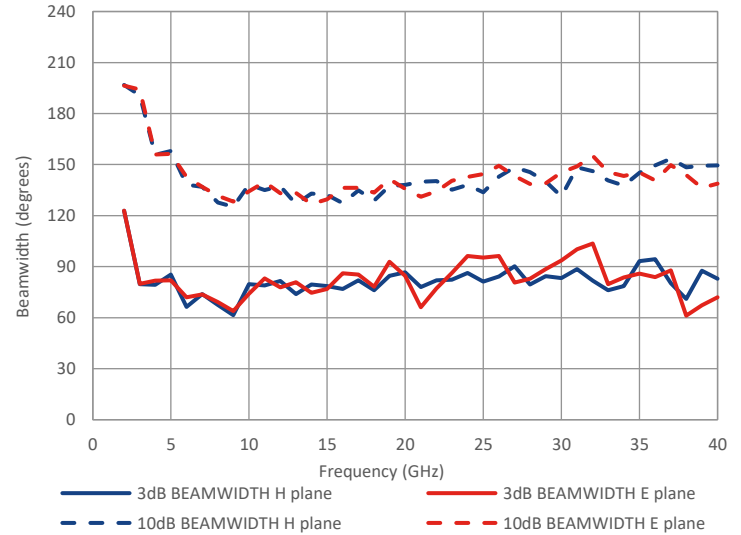

Typical VSWR

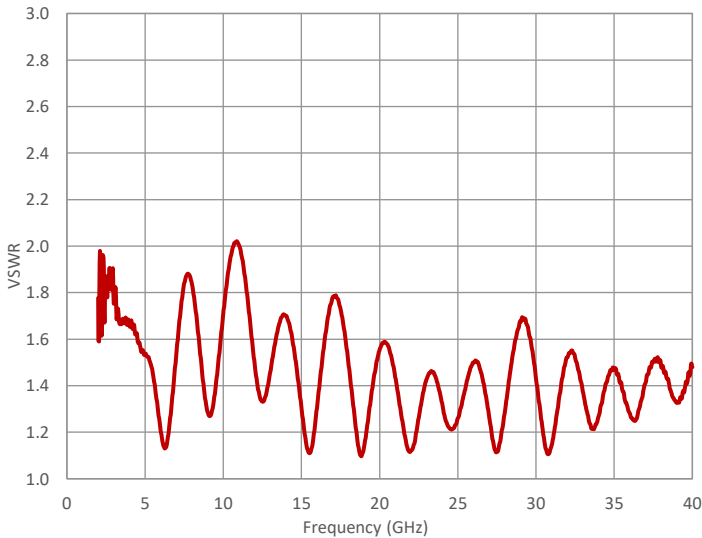

Typical Axial Ratio

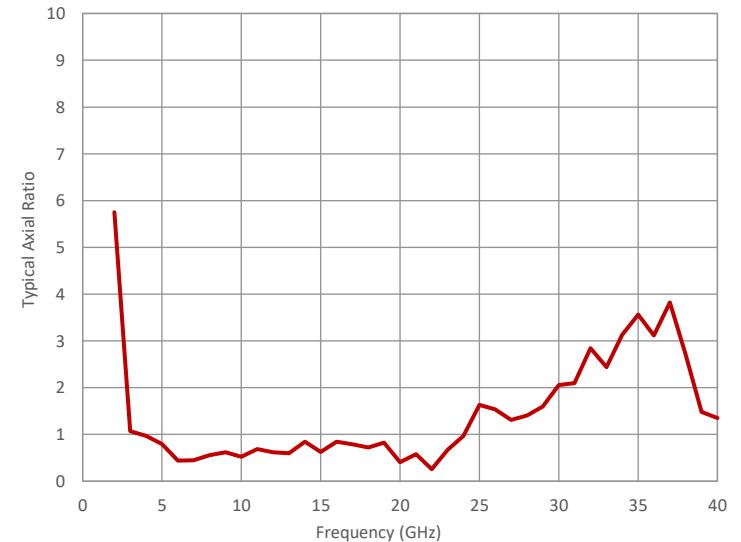

Steatite Antennas reserve the right to change and/or update this specification whereby it is deemed that this would improve either the production and/or performance specification of this part. Information herein should not be disclosed to a third party without the prior written consent of Steatite Antennas.

BP 12/06/2024 1412

