

1 - 4.2 GHz Linearly Polarised Wideband High Gain Ridged Horn Antenna fitted with a 7:16 DIN type Connector

Catalogue number **QWH-SL-1-4.2-A-SG**

Q-par reference **QMS-00057**

Contents **Summary**
Typical Gain / Antenna Factor
Typical Beamwidth / Patterns
VSWR

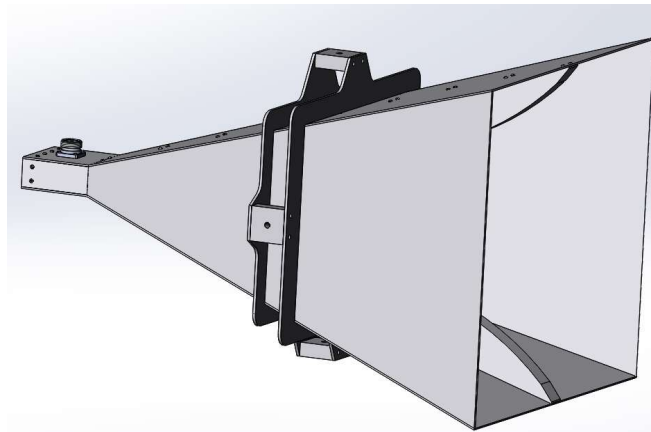

1 GHz

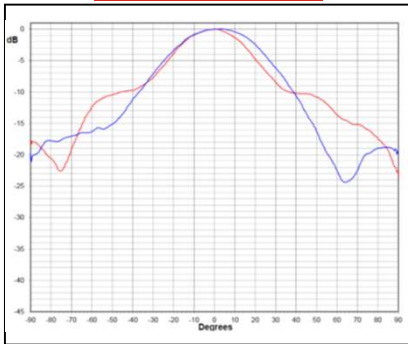

1.8 GHz

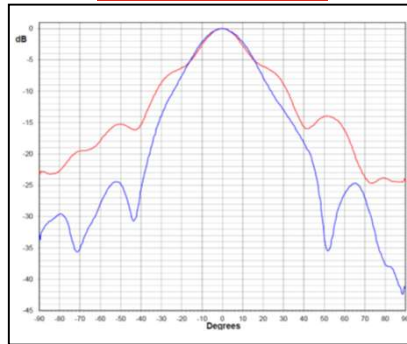

2.6 GHz

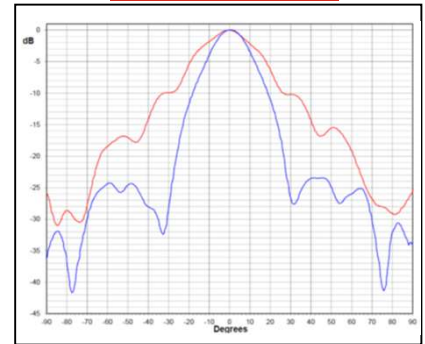

3.4 GHz

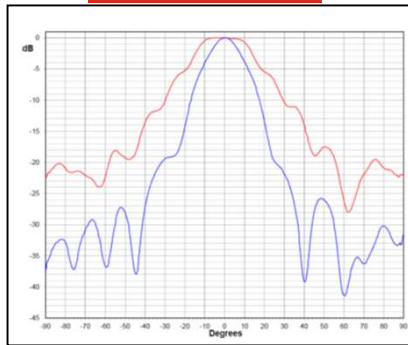

4.2 GHz

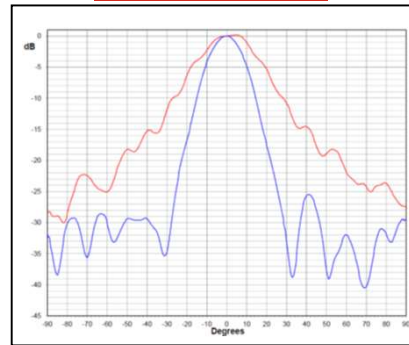

Red trace = E-plane, Blue trace = H-plane cut

Freq	Gain @1m	AF @1m	Freq	Gain @1m	AF @1m
GHz	dB	dB/m	GHz	dB	dB/m
1.00	13.00	17.23	2.80	11.70	27.47
1.10	13.20	17.86	2.90	11.80	27.68
1.20	13.40	18.41	3.00	12.20	27.57
1.30	13.50	19.01	3.10	12.10	27.96
1.40	13.00	20.15	3.20	11.80	28.53
1.50	12.90	20.85	3.30	12.00	28.60
1.60	13.50	20.81	3.40	12.00	28.86
1.70	12.90	21.94	3.50	12.10	29.01
1.80	12.95	22.39	3.60	12.20	29.16
1.90	12.80	23.01	3.70	12.50	29.09
2.00	13.00	23.25	3.80	12.40	29.43
2.10	12.00	24.67	3.90	12.00	30.05
2.20	13.10	23.98	4.00	10.20	32.07
2.30	12.80	24.66	4.10	12.00	30.49
2.40	12.10	25.73	4.20	12.10	30.59
2.50	11.60	26.59	4.30	12.40	30.50
2.60	11.00	27.53	4.40	12.80	30.30
2.70	10.80	28.06	4.50	13.20	30.09

Typical Specification

Frequency	1 to 4.2 GHz
Connector Type	7:16 DIN type jack
Power Handling	1200 Watt c.w. at 4 GHz, 6 kW peak
VSWR	2.0:1 max, < 1.5:1 typical
Gain	13.6 to 18.4 dBi
Antenna Factor	16.6 to 43.1 dB/m
3dB Beamwidth	13 to 40 degrees
10dB Beamwidth	27 to 82 degrees
Weight	11.2 kg nominal
Maximum Size	547 x 485 mm external aperture x 803 mm long
Mounting	2 x Mounting spigots at centre of gravity tapped 1/4" UNC x 16 mm deep
Construction	Welded aluminium horn, powdercoat finish. Plated brass, stainless steel & PTFE connector

Typical Antenna Gain / Factor

This is calculated by reference to standard gain horn antennas, and cross checked with reference to the antenna beamwidth, with an estimated error of +/- 0.8dB.

